

# Subaru STI Front Track Knucle Kit

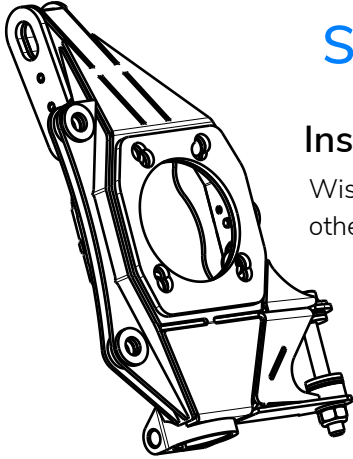

## Installing the knucle

Wisefab Subaru Drop Knuckles are designed to use OE bolts and hardware. For other cases the correct bolts are included in the kit.

## Selection of models

The knuckles are designed for a wide range of Subaru models. This kit includes a selection of accessories that suit different Subaru models.

### STI

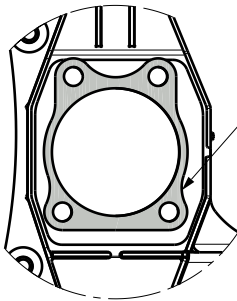

When using STI front hubs/bearings (5x114,3) the hub spacers need to be installed.

When using STI shocks the shock spacers need to be installed.

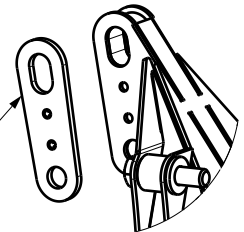

### WRX

When using WRX front hubs/bearings (5x100) the plastic centering rings need to be installed. With WRX bearings the inner bolt holes need to be used.

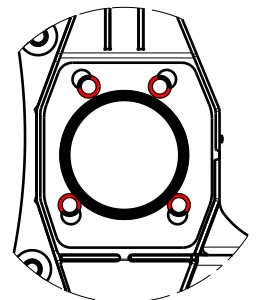

## Wheel speed sensor

Below is the sortiment of wheel speed sensor plates. Choose the correct plate when installing wheel speed sensor.

STI 2005-2007   STI 2007-2013   WRX 2007-2013



## CV joint spacer

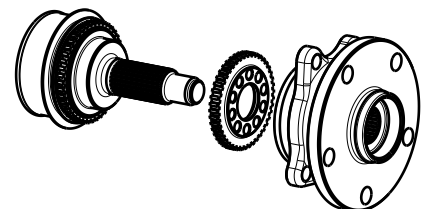

CV joint spacer must be used when the driveshafts are from up to 2005 STI or WRX. Wheel speed sensor then bolts directly to the knucle.



If you still have some trouble installing the kit, contact us at [sales@wisefab.com](mailto:sales@wisefab.com), or call us +372 5562 5669

# Subaru STI Front Track Knucle Kit

## Installing the tierod



\*Models until 2007 must place the 10mm bushing to the bottom.

Additional bump steer adjustment is done with the rest of the included washers.

\*2007 and newer models must place the 10mm bushing on the top.

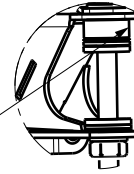

## Installing the rack extender

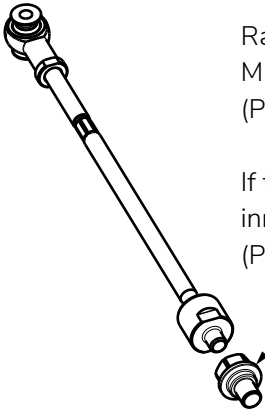

Rack extender included in the kit is for a steering rack with inner tie rod fixing thread of M16x1.5. If the steering rack used has M14x1.5 then the extender has to be ordered separately (Part number WFGD3\_620A).

If the steering rack is from a VA series Subaru WRX or WRX STI from 2014 and later with the inner tie rod fixing thread of M20x1.5 then the rack extender has to be ordered separately (Part number WFGD3\_610A).

Rack extender

## IMPORTANT!

If the kit is installed check the clearance between car body, suspension components and the wheel with tire in all extent of the suspension travel. For that the spring needs to be removed. If there is clearance issues then change your wheel alligment or limit the suspension travel.

## Specs

- Camber: no change with OEM
- Caster: no change with OEM
- Front track: same as the OEM
- Strut lenght (A): same as the OEM
- Wheel backspace (B): same as the OEM
- Wheel diameter min: 17"

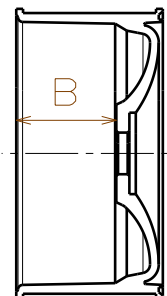
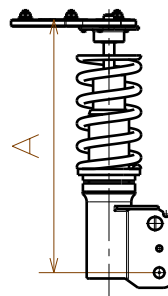

If you still have some trouble installing the kit, contact us at [sales@wisefab.com](mailto:sales@wisefab.com), or call us +372 5562 5669