

BMW F2x Rear

Overall view of assembled components in the right corner

All lengths are pre set by Wisefab.
No need to adjust before alignment.

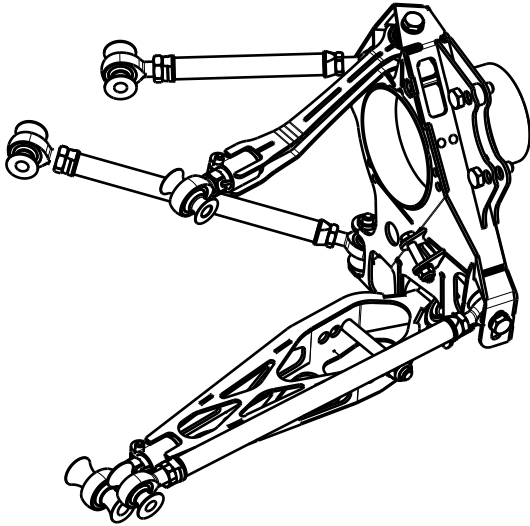

Installing the toe arm (#4)

Holes are oval for adjusting bumpsteer.
If bumpsteer is not measured leave the arm at the middle of the mark on the knuckle.

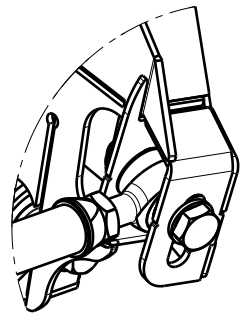

Installing the upper forward link (#7)

BMW F2x rear kit has a built in anti-squat adjustment.
Moving the arm upwards, gives you less anti-squat.
Moving it down, gives you more.

Less anti-squat - better over bumps on throttle.
More anti-squat - better launches, needs more power to spin the tires.

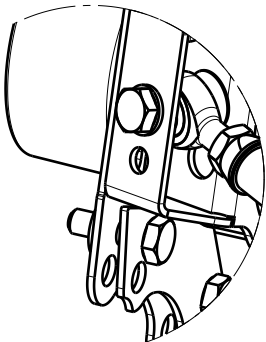

Installing the brakes

Wisefab F2x rear knuckle has a compatibility for two brake sizes from E9x.

OE: (34216764655 or 34216855004) 336 X 22mm Big Brake setup.

OE: (34212283387 or 34212283803) 350 X 24mm M Brake setup.

For the Big brake setup use the inside holes and spacer plate installed to the upright

For the M brake setup remove the spacer plate and use the outer holes.

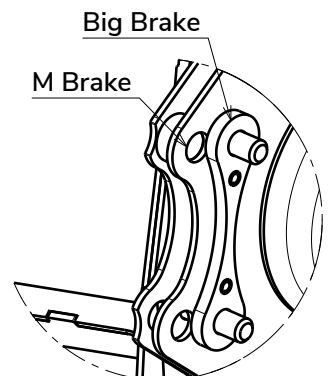

**FOR RACING
USE ONLY**



If you still have some trouble installing the kit, contact us at sales@wisefab.com, or call us +372 5562 5669

BMW F2x Rear

Component fitment

Wheel bearing

Rear wheel bearing has to be sourced from BMW E90. Only the bigger size wheel bearing can be used 45x85x41.
(Part number 33416775842)

Wheel hub

Wheel hub can be sourced from BMW E90 and should be for the bigger wheel bearing. (Part number 33416760058)

Drive shaft

Driveshaft has to be from BMW E90 or E90 M3 or an aftermarket one that fits E90

Brakes

OEM F2x brakes do not fit. Brake calipers and discs can be sourced from E90

Recommended alignment specs

Camber: -0,5deg

Toe: 3-10mm toe in/per side

Rear track: 30 mm narrower per side than OEM

Strut length (A) max: 520 mm

min: 405 mm

Wheel backspace (B) max 19": 185 mm

18": 185 mm

17": 185 mm

Some 17" wheels will not fit

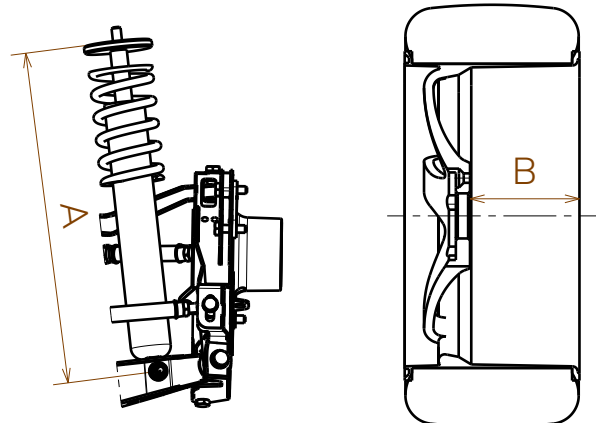

IMPORTANT!

If the kit is installed check the clearance between car body, suspension components and the wheel with tire in all extent of the suspension travel. For that the spring needs to be removed. If there is clearance issues then change your wheel alignment or limit the suspension travel.

**FOR RACING
USE ONLY**



If you still have some trouble installing the kit, contact us at sales@wisefab.com, or call us **+372 5562 5669**