

Nissan Z370-Chassis installation guide

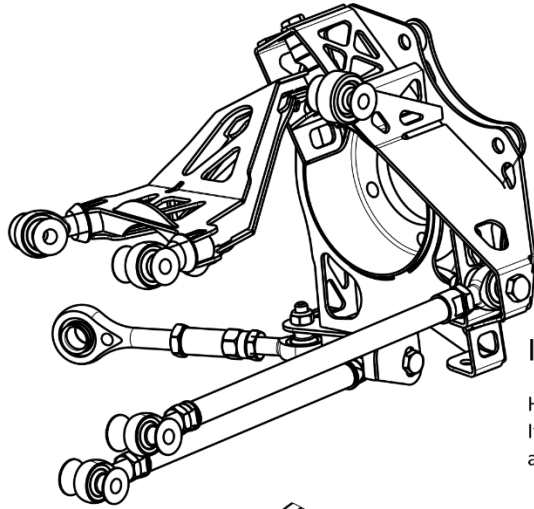

Overall view of assembled components in the right corner

All lengths are pre set by Wisefab.
No need to adjust before alignment.

Installing the toe arm

Holes are oval for adjusting bumpsteer.
If bumpsteer is not measured leave the arm at the middle.

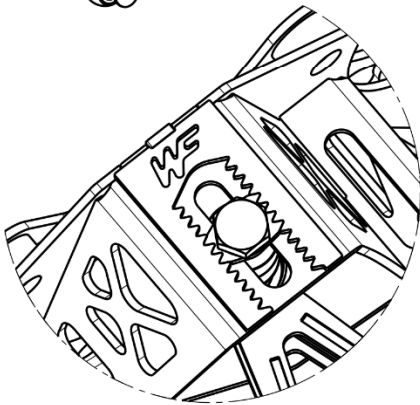
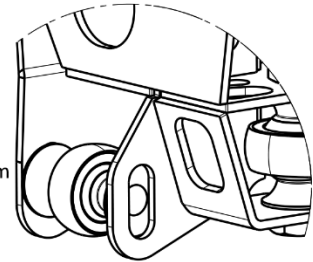

Installing the upper A arms.

When installing the upper A arms, make sure that the arm will be at the bottom most position. There is a camber adjustment built in to the knuckle. Possible to move half step by rotating 180° the toothed washer. When adjusting camber, toelink correction is needed to keep the same toe. See the chart below with specs. 1flat equals 1/6 toelink turn

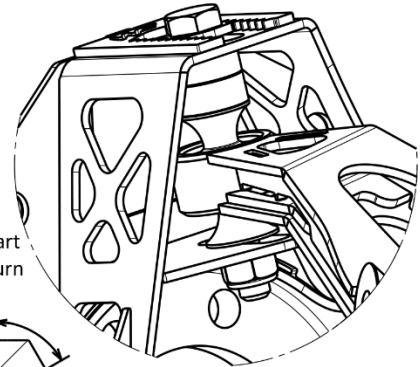

Adjusting the toelink

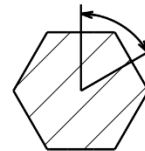

1flat = 1/6 turn

	Influence		Toelink correction		Toelink sensitivity
	Camber change	Caster change	Toelink adustment per side to keep the same toe	Direction	
Camber adjustment 1 full step	1,3°	0	5flats	More neg camber = shorter toelink	11,7flats = 1° of toe change 1flat = 0,08° of toe change
Camber adjustment 1/2 step	0,65°	0	2,5flats		

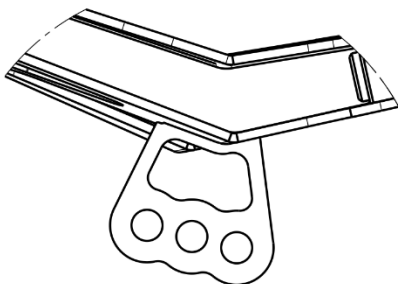

Adjustable swaybar motion ratio.
Adjusting it closer to car centerline - wheelrate is softer.
Opposite direction - wheelrate is stiffer

Recommended alignment specs

Camber: -0,5deg
Toe: 3-10mm toe in/per side



If you still have some trouble installing the kit, contact us at sales@wisefab.com, or call us +372 5562 5669