

Toyota GT86 Track

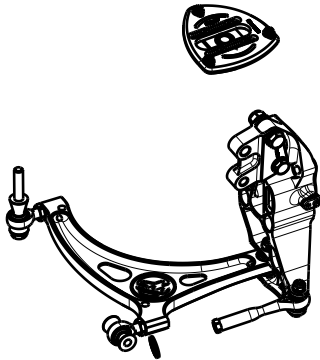

Overall view of assembled components in the right corner

All lengths (exc. tie rod)and camber plates are pre set by Wisefab. No need to adjust before alignment

Installing the lower control arm

The OE forward mounting bolts are no longer needed. Kit includes replacement bolts..

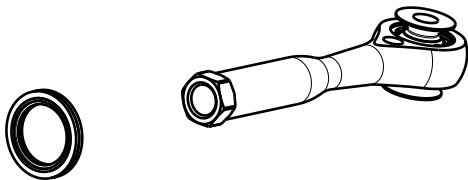
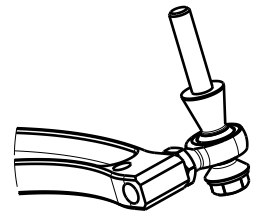

Tie rod washers

Wisefab kit has a quicker steering ration. With that in mind, there are 4pcs of washers included that can be used on the steering rack shaft to limit the usable turning ratio. These washers are also usefull if there is a bigger wheel in use. Use these washers to prevent the wheel from contacting the chassis.

Coilover adapter

This adapter is needed if there is a clearance issue with the coilover.

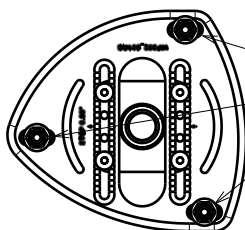
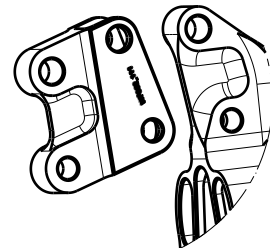

Installing the camber plates

When installing the camber plates tighten the mounting bolts with 50Nm max.

**FOR RACING
USE ONLY**



If you still have some trouble installing the kit, contact us at sales@wisefab.com, or call us +372 5562 5669