

Nissan GT-R front installation guide

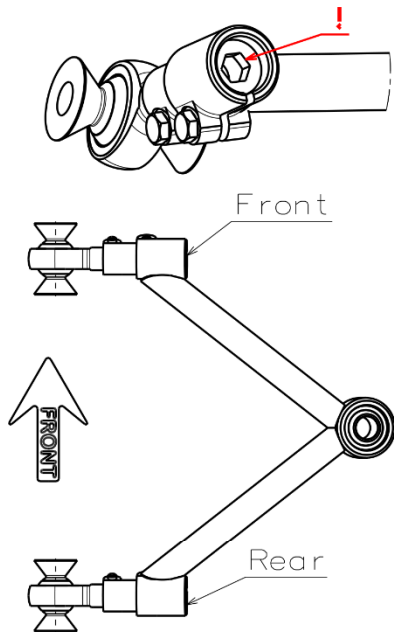

Installing the upper control arm

Wisefab upper control arm has a built in camber and caster adjustment.

*Adjusting both rod ends to the **same direction**, camber is adjusted.

* Adjusting rod ends **opposite direction** of each other, caster is adjusted.

When adjusting camber, **toelink correction** is needed. 1 flat adjustment equals 1/6 of toelink turn

See the chart below.

Adjusting the toelink

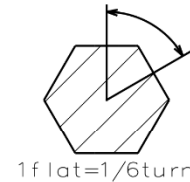

	Upper A-arm adjustment		Influence		Toelink correction		Toelink sensitivity
	Front	Rear	Camber change	Caster change	Toelink adj. per side to keep the same toe	Direction	
Same direction	1 turn	1 turn	0,3°	0°	1 flat	more neg camber - shorter toelink	1flat = 0,11° toe change
Opposite direction	1 turn	-1turn	0°	0,65°	0,7 flat	more caster - shorter toelink	9flats = 1° toe change

Installing the tierod

Nissan GT-R kit includes special washers. These are for steering lock adjustment. Wisefab knuckle has a quicker steering ratio. With stock rack travel steering lock is bigger. Use as many washers a needed to avoid rubbing. 4 washers recommended on each side.

Washers that are included with the knuckle are for adjusting bumpsteer and used for different setups.

Setups are on the other side of the page.

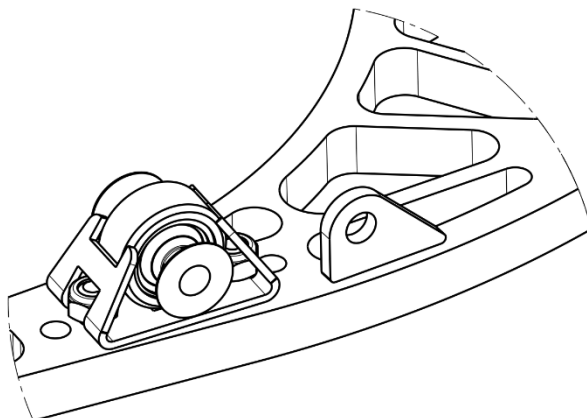
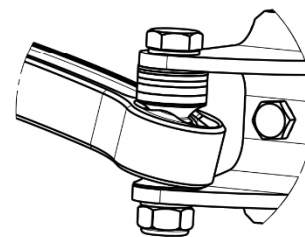
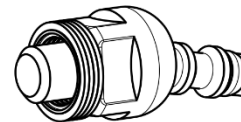

Motion ratio

You can adjust motion ratio (ride/roll stiffness) by changing the coilover mounting point on the arm. Moving it outwards, ride/roll will be stiffer. Moving it inwards, ride/roll will be softer.



If you still have some trouble installing the kit, contact us at sales@wisefab.com, or call us +372 5562 5669

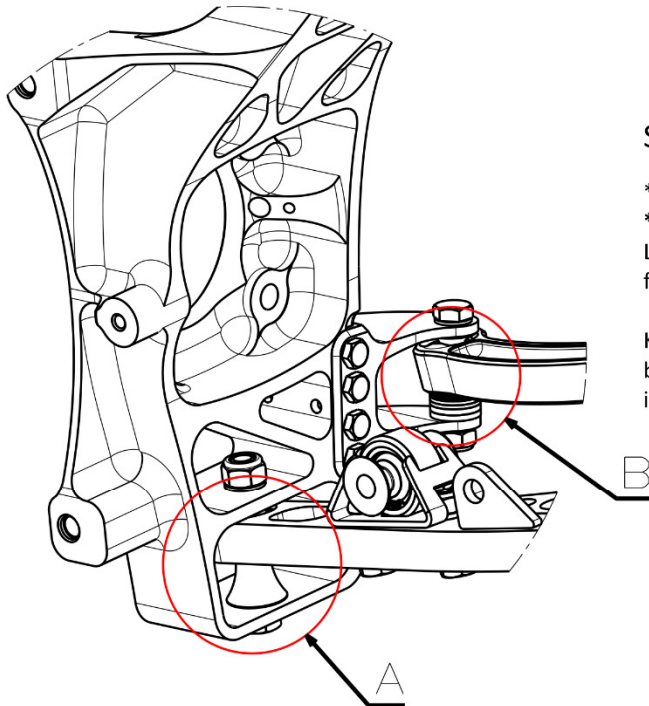

Setup 1

*For a **lowered car with a small wheel (660mm diameter)**
 ***Standard ride height and big wheel (710mm diameter).**
 Lower control arm assembled by Wisefab for this setup. (Fig. A)

Kit includes washers, which are for adjusting bumpsteer. If bumpsteer is not measured install the tierod to the top most position (Fig. B)

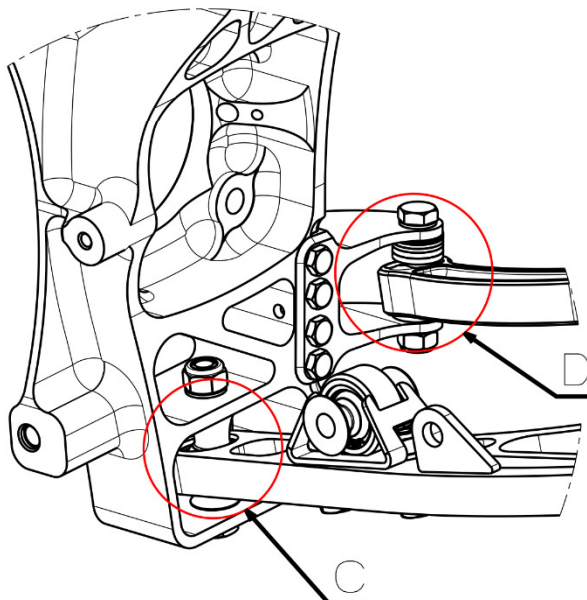

Setup 2

*For a **lowered car with a big wheel (710mm diameter).**
 Wisefab lower control arm is assembled for setup 1. Spacers must be switched for setup 2 (Fig. C)
 If bumpsteer is not measured install the tierod to the most bottom position (Fig. D)



If you still have some trouble installing the kit, contact us at sales@wisefab.com, or call us +372 5562 5669