

# Hydraulic Handbrake

## Rear cylinder

### Order of assembly

1. Install spacers to handle. See drawing for correct position.
2. Thread rod end to cylinder.
3. Bolt cylinder to bracket.
4. Install return spring to handle.
5. Fit handle to bracket.
6. Torque all bolts to 25Nm/18lb-ft.

Mount the spring on the lower spacer and attach spring to these locations

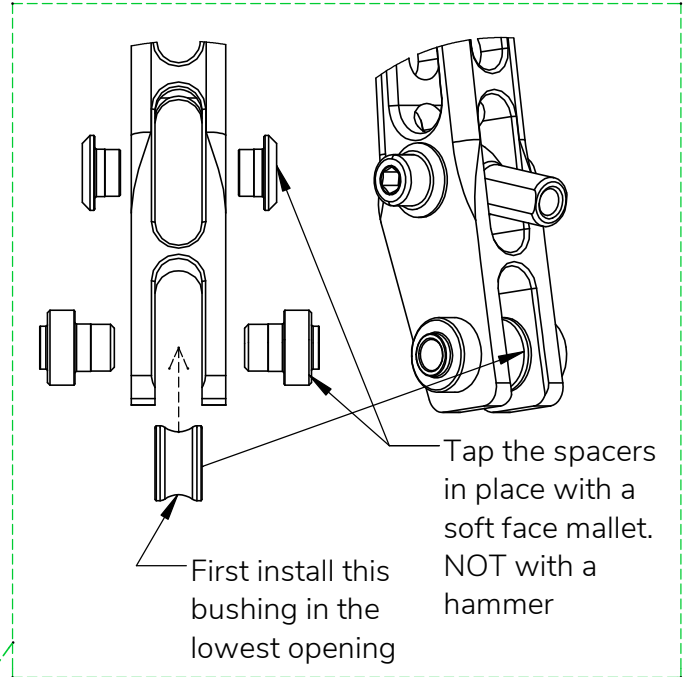
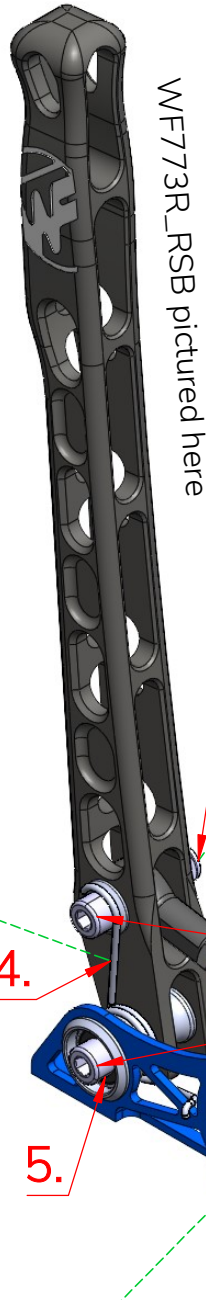
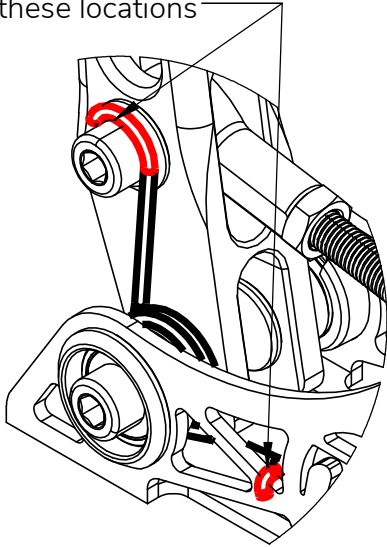

### Mounting pattern

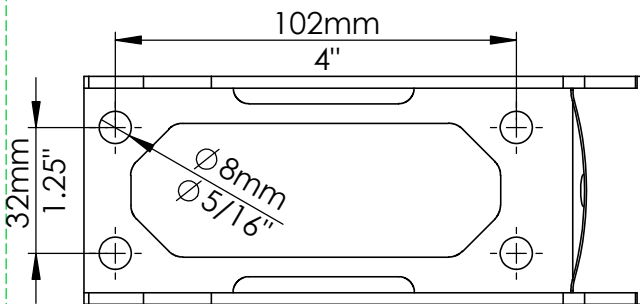

3/8-24 UNF double flare with adapter

### Fittings

7/16-20 UNF double flare

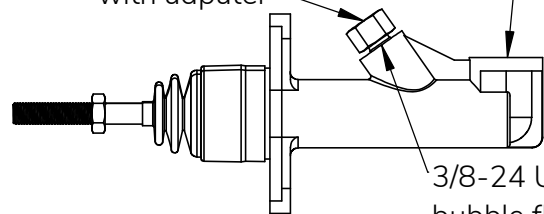

3/8-24 UNF bubble flare without adapter



If you still have some trouble installing the kit, contact us at [sales@wisefab.com](mailto:sales@wisefab.com), or call us +372 5562 5669

# Hydraulic Handbrake

## Front cylinder

### Order of assembly

1. Install spacers to handle. See drawing for correct position.
2. Thread rod end to cylinder.
3. Bolt cylinder to bracket.
4. Install return spring to handle.
5. Fit handle to bracket.
6. Torque all bolts to 25Nm/18lb-ft.

WF773F\_RSB pictured here

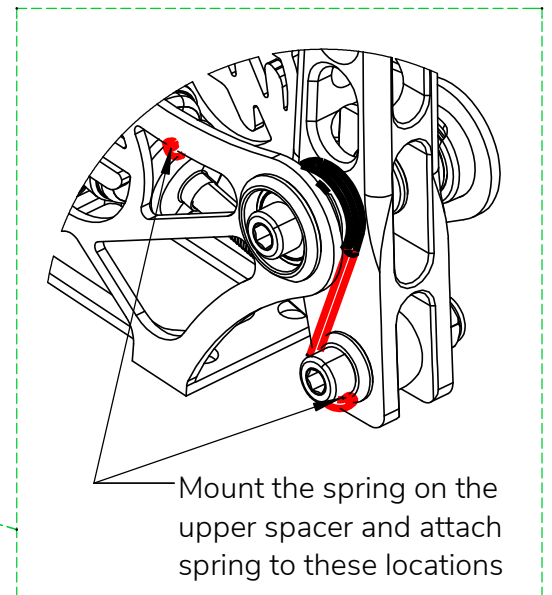
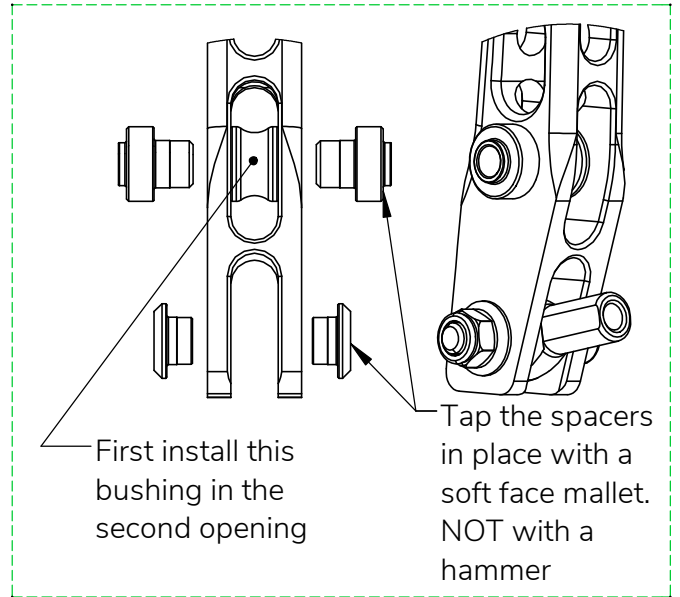
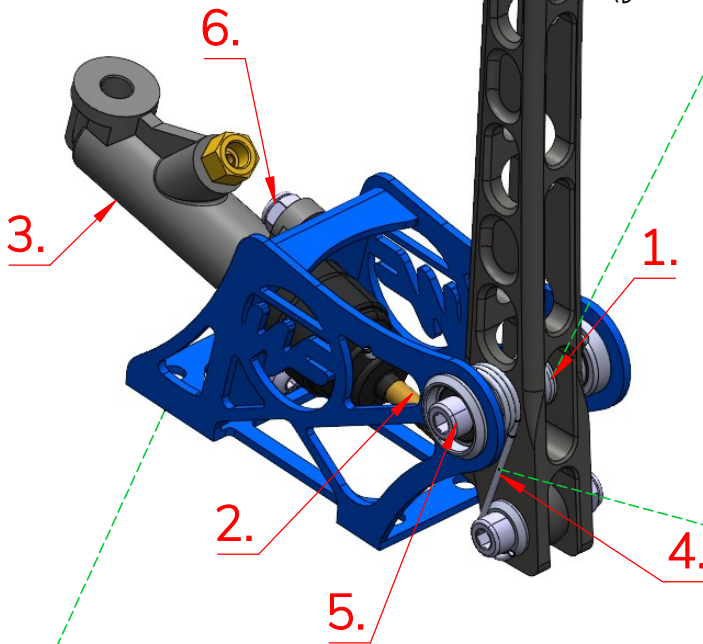

### Mounting pattern

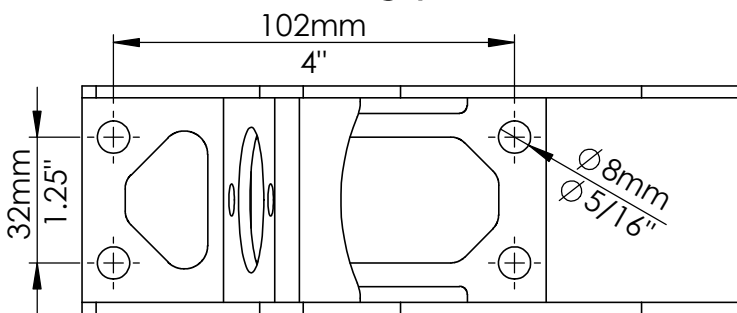

3/8-24 UNF double flare with adapter

### Fittings

7/16-20 UNF double flare

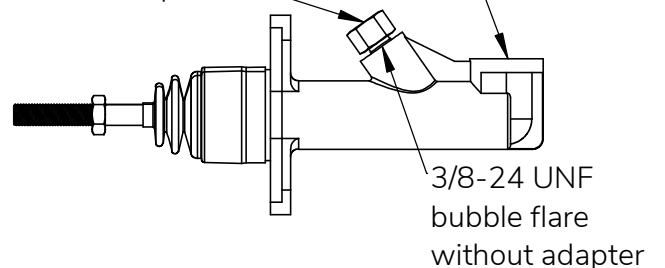

If you still have some trouble installing the kit, contact us at [sales@wisefab.com](mailto:sales@wisefab.com), or call us +372 5562 5669