

Mazda RX-8 Front Lock Kit

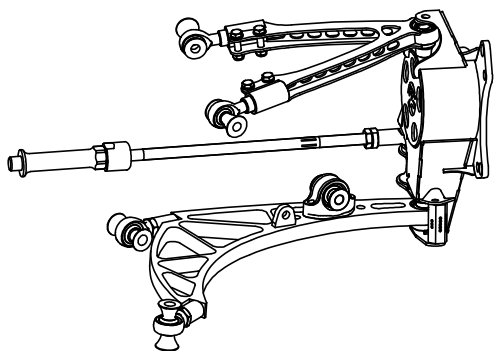

Overall view of assembled components in the right corner

All lengths (exc tie rods) are pre set by Wisefab. No need to adjust before alignment.

Installing the upper A arms

Upper arms are not symmetrical.
Shorter link must face forward.

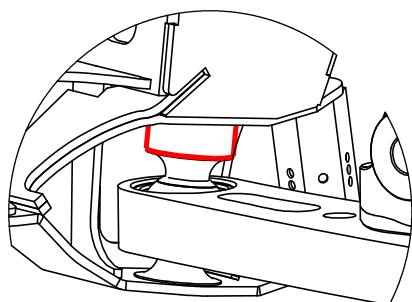
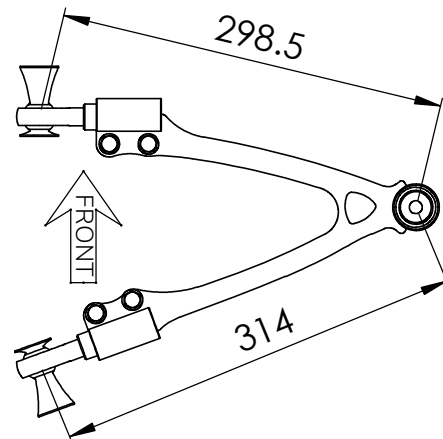

Installing the lower A arms

Arm must be installed in the lower position.
Spacer bushing goes above the spherical joint.
Mount arms with stock bolts,
we recommend using new ones.

Adjusting suspension stiffness

You can adjust motion ratio (ride/roll stiffness) by changing the coilover mounting point on the control arm.

Moving it outwards, ride/roll will be stiffer.

Moving it inwards, ride/roll will be softer.

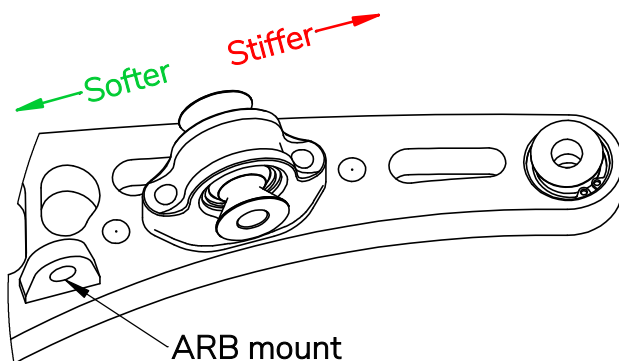
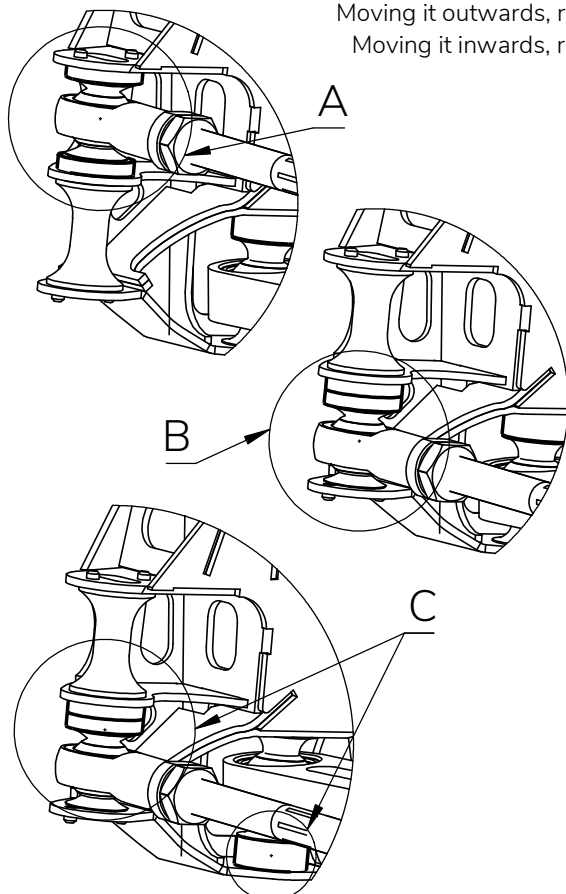

Installing the tierods

A - When using original rack location, install the tierod to upper position of the knuckle and between the two washers (fig. A).

B - When using Wisefab relocated BMW rack, install the tierod to the lower position of the knuckle and both washers on top of the tierod (fig. B).

Lowering the rack further (to clear oil pan etc)

C - If the rack is lowered 10mm from Wisefab relocated rack location, then the lower control arm spacer bushing goes below the spherical joint.
Tierod stays at the lower position (fig. C).

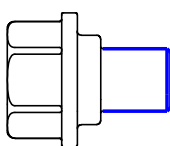

Installing the rack spacer

Before installing the rack spacer, use thread locker on the threads between the steering rack and rack spacer

How to adjust Double Adjuster

Step 1. Loosen rodend locking nut with **8mm Allen** key by turning it counter clockwise.

Step 2. Slightly loosen the pinch bolts

Step 3. Turn Double Adjuster with **10mm Allen** key. Turning it counter clockwise will make the Double Adjuster assembly longer, turning it clockwise will make it shorter.

Step 4. Tighten the pinch bolts

Step 5. Tighten rodend locking nut with **8mm Allen** key by turning it clockwise.

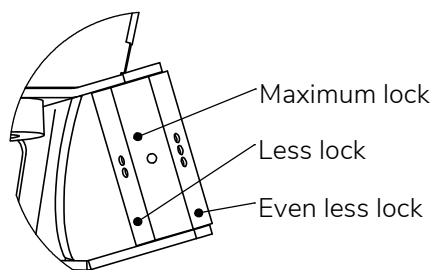

Lock stopper adjustment

Wisefab lock kits are equipped with hexagonal lock stoppers, where each side has a different offset.

The more dimples, the more offset and by that less usable lock.

When installing, make sure that Tie rod is not binding in any way.

IMPORTANT!

When the lock stopper is set, check the clearance between car body, suspension components and the wheel with tire in all extent of the suspension travel. For that the spring needs to be removed. If there is clearance issues then limit the steering lock more, limit the suspension travel or change your wheel alignment.

Recommended alignment specs

Camber: -3.5°

Caster: 5.5°

Toe: if ackerman is 0 or negative, use 2mm toe-out,
if ackerman is positive, use 0mm toe.

Front track: 80 mm wider per side than OEM

Strut lenght (A) :

max: 540 mm

ride height: 475mm

min: 440 mm

Wheel backspace (B) :

max 19": 140 mm

18": 140 mm

17": 135 mm

Some 17" wheels will not fit

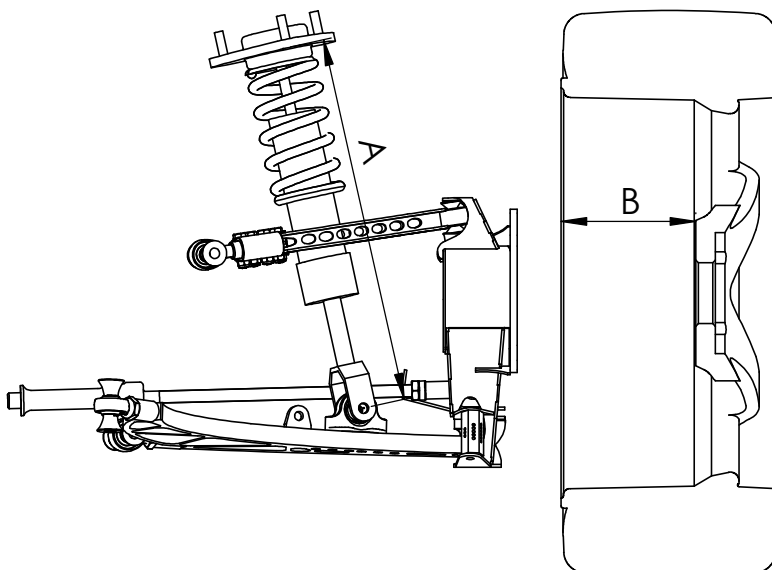

If you still have some trouble installing the kit, contact us at

sales@wisefab.com, or call us **+372 5562 5669**