

## BMW E36/E36M/E46/E46M Front lock kit

### Difference between WF360; WF460 and WF4601

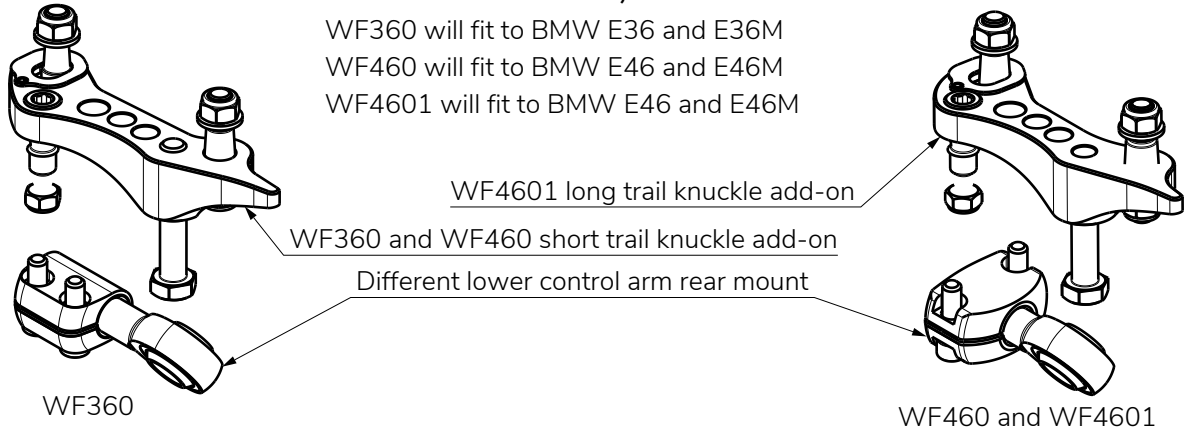

### Knuckle add-on

Make sure that the knuckle and knuckle add-on mating surfaces are clean and flat. The knuckle add-on surface must be in full contact with the knuckle.

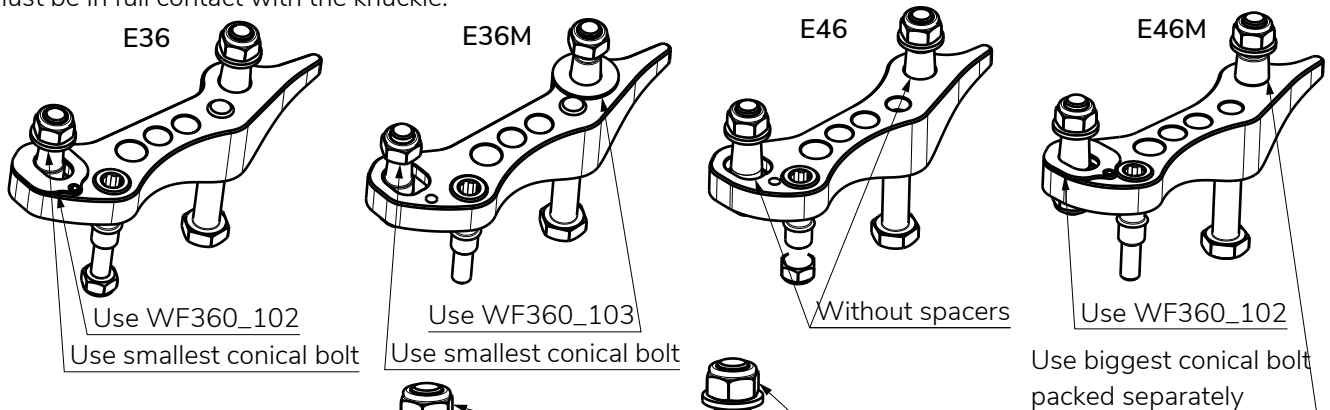

1. Stack **two** ACK Washers into one add-on
2. Fit the knuckle add-on to the knuckle loosely

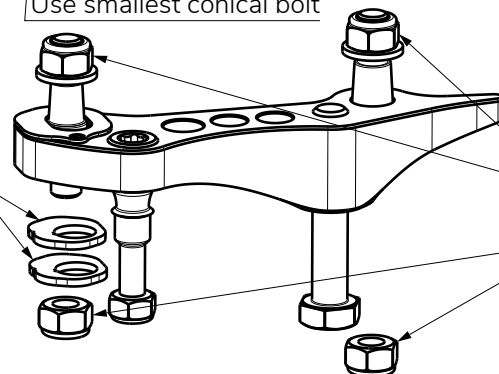

4. Fully tighten the top nuts first.
5. Then tighten the lower nuts

If the top nuts are not tightened first, the knuckle add-on may come loose

### Ackermann

Can only be adjusted from near parallel steering (ACK0) to 2 positive Ackermann setups (ACK3;ACK6)

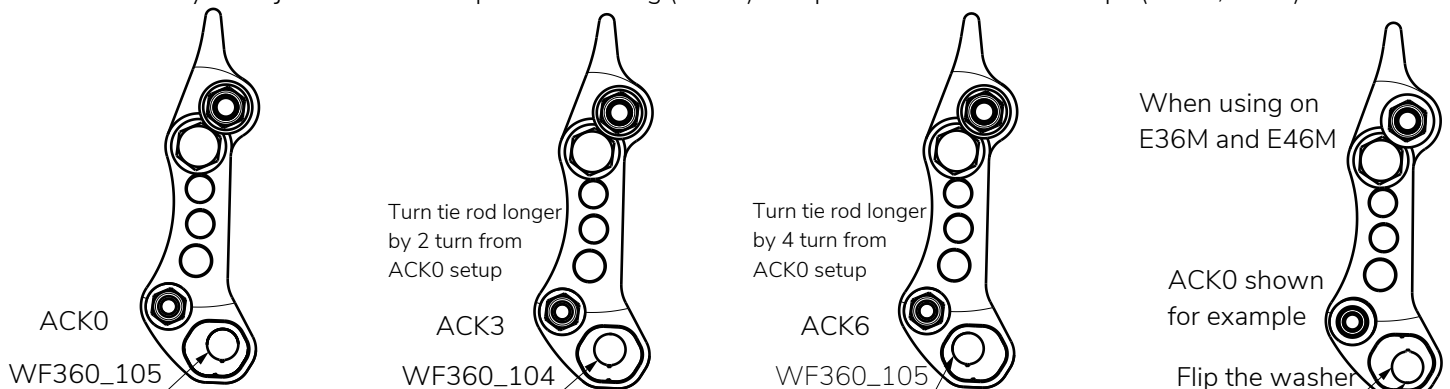

**FOR RACING  
USE ONLY**



If you still have some trouble installing the kit, contact us at [sales@wisefab.com](mailto:sales@wisefab.com), or call us +372 5562 5669

## Tie rod fixing

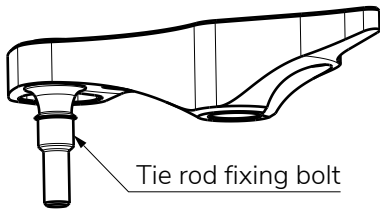

Tie rod fixing bolt

If the tie rod fixing bolt needs to be changed then use thread lock and tighten to 120Nm

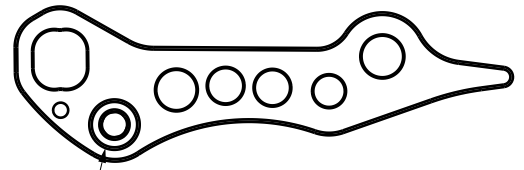

Turn counter clockwise to tighten

## Top Mount

E36

Both sides bolts in the middle of the slot

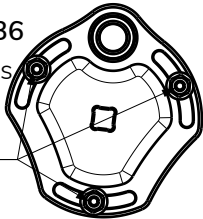

Right side shown in the picture

E46

Forward most bolt near the spherical bearing

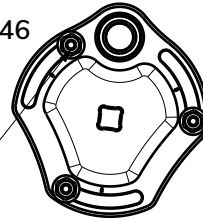

This is the recommended top mount alignment before doing the final wheel alignment

## Lower control arm rear mount

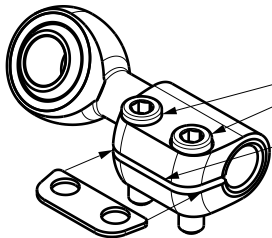

Loosen the two bolts to adjust caster

Make sure there is a spacer between the slot

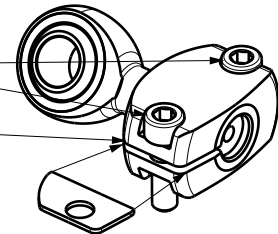

## Lock stopper adjustment

BMW E36 and E46 Wisefab kit are equipped with hexagonal lock stoppers, where each side has a different offset. The more dimples, the less steering lock. When installing make sure that tie rod is not binding in any way.

### IMPORTANT!

If the lock stopper is set check the clearance between car body, suspension components and the wheel with tire in all extent of the suspension travel. If there is clearance issues then limit the steering lock more or change your wheel alignment. After the first shake down check that all the nuts and bolts are tight

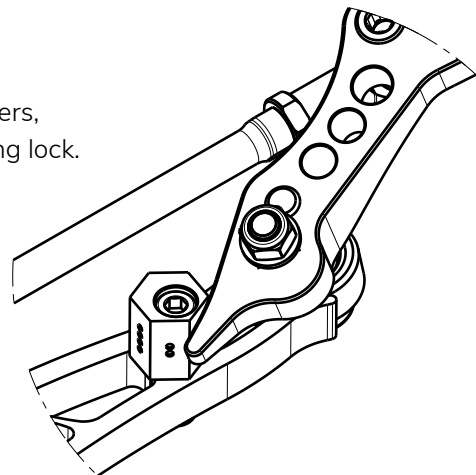

## Recommended alignment specs

Camber: E36 -6°; E46 -4°

Caster: E36 5°; E46 6°

Toe: if ackerman is 0 or negative then toe is 2 mm,  
if ackerman is positive then toe is 0.

Front track: E36 105 mm; E46 74 mm wider per side then OEM

Strut lenght (A) max: E36 500 mm; E46 510 mm  
min: E36 340 mm; E46 310 mm

Wheel backspace (B) max 19": 145 mm  
18": 145 mm  
17": 140 mm

Most 15" wheels will not fit

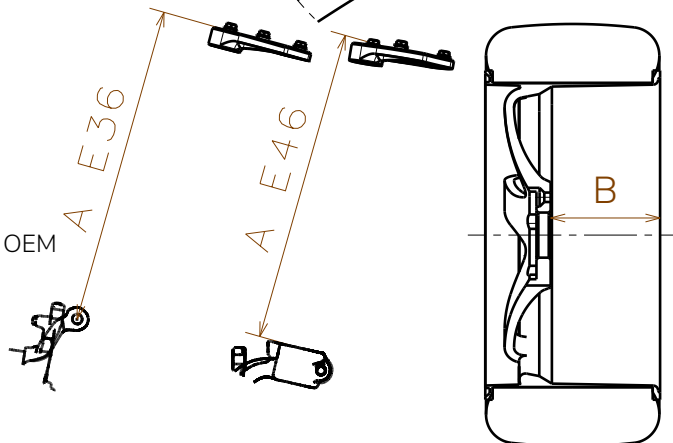

If you still have some trouble installing the kit, contact us at [sales@wisefab.com](mailto:sales@wisefab.com), or call us +372 5562 5669