

## Honda S2000 front installation guide

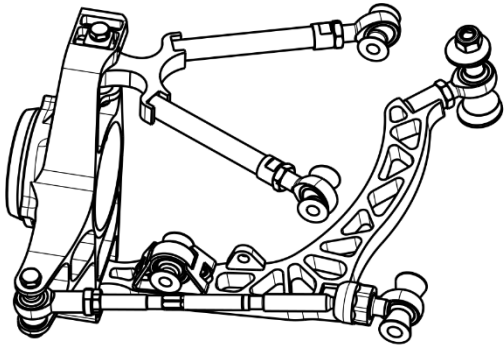

### Overall view of assembled components in the right corner

All lengths are pre set by Wisefab.  
No need to adjust before alignment.

### Installing the upper front arm

Wisefab knuckle has a camber adjustment built in to the knuckle. When adjusting camber loosen the bolt and the car should be lifted.

Toelink correction is needed when adjusting camber. See the chart below with specs. 1flat equals 1/6 toelink turn

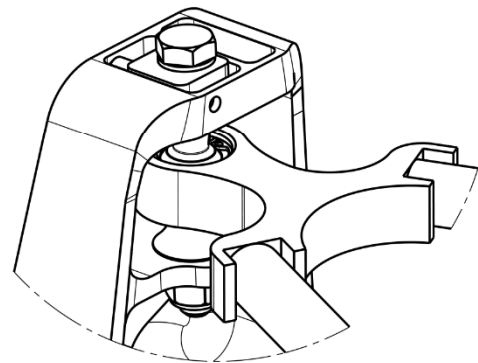

Camber screw adjustment	Influence	Toelink correction		Toelink sensitivity
	Camber change	Toelink adjustment per side to keep the same toe	Direction	
1 turn	0,25°	2flats	more neg camber = shorter toelink	10flats = 1° of toe change 1flat = 0,1° of toe change

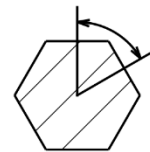

1flat = 1/6 turn

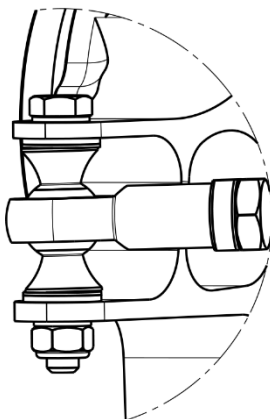

### Installing the tierods

When installing tierods there are some washers included. These washers are for adjusting bumpsteer. If bumpsteer is not measured leave the arm at the middle.



If you still have some trouble installing the kit, contact us at [sales@wisefab.com](mailto:sales@wisefab.com), or call us +372 5562 5669