

## Honda S2000 rear installation guide

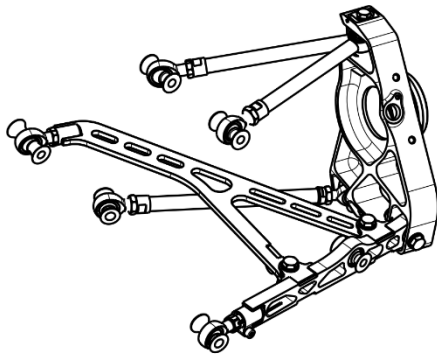

### Overall view of assembled components in the right corner

All lengths are pre set by Wisefab.  
No need to adjust before alignment.

### Installing the upper control arm

Wisefab knuckle has a camber adjustment built in to the knuckle. When adjusting camber loosen the bolt and the car should be lifted.  
With small camber adjustments toelink adjustment is not needed. See the chart below with specs. 1flat equals 1/6 toelink turn.

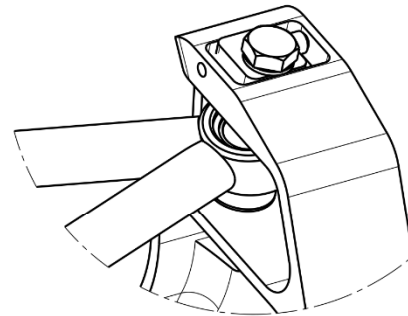

Camber screw adjustment	Influence Camber change	Toelink correction		Toelink sensitivity
		Toelink adjustment per side to keep the same toe	Direction	
1 turn	0,25°	0,25flats	More neg camber = shorter toelink	5,8flats = 1° of toe change 1flat = 0,17° of toe change

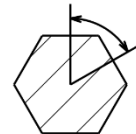

1flat = 1/6 turn

The upper control arm is not not symmetrical. The longer link goes to the forward mount. Kit includes additional spacers, these are for the AP1 chassis. When installing kit to AP1 chassis, the A arm inner spacers need to be changed.

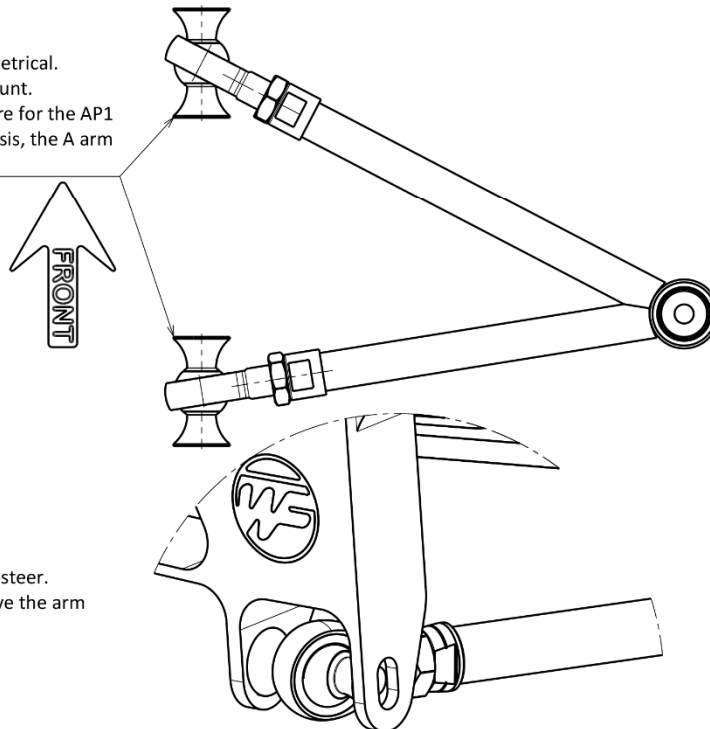

### Installing the toelink

Holes are oval for adjusting bumpsteer. If bumpsteer is not measured leave the arm at the middle.



If you still have some trouble installing the kit, contact us at [sales@wisefab.com](mailto:sales@wisefab.com), or call us +372 5562 5669